



Support column with locking device

Land loading arms

Features

- Available in carbon steel or stainless steel
- Support up to 2 loading arms
- Including locking device to lock the loading arm(s) in resting position
- Painted according specifications or hot dip galvanized

Options

- Position detection of the loading arm(s) in resting position
- Installation of a junction box or control instruments

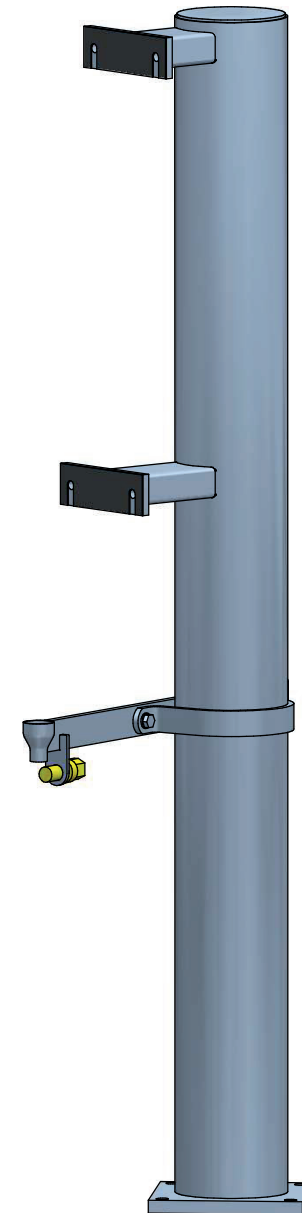

Wiese Europe bvba

Smederijstraat 16
2960 Brecht
Belgium

+32 3 633 16 10

info@wiese-europe.com
www.wiese-europe.com

